



Service Letter

SL: 40017
Date: 1 December 2010
Product: Compressors
Subject: 7/26 - Coolant Header Tank Replacement For Aftermarket

MODEL	SERIAL NUMBER
7/26	102100 - 119999 220000 - 221499

Doosan Infracore would like to inform its dealers that for the 7/26 compressors listed above, the coolant header tank is out of production and has been replaced by a new one. When replacing the coolant header tank, order the complete kit (p/n 46556711).

Kit Content

ITEM	P/N	DESCRIPTION	QTY.
1	46553372	Bracket, DOGA Header	1
2	36797652	Screw TPG M06-100 x 012 CTD	4
3	22246417	Tank, Header Assy 7/20 (DOGA)	1
4	92096015	Screw M6x16, Flanged, Whizlock	3
5	92304591	Washer M6, Large Type D	3
6	92829316	Locknut M6, Nylon Insert	3
7	22352348	Hose, Header Tank-Cooler 5x1.5	700 mm
8	54576624	Hose, 5/16" (8MM) ID Diesel	200 mm
9	46556670	Connector, Barbed Reduced Hose 8/Hose 10	1
10	22921092	Clip, Norma Cobra 12	2
11	54577275	Clamp, Hose 18,2-20,5 MM	1
12	22307672	Hose, Fkd 20/28 MM	70 mm
13	46556671	Elbow, Hose 20 MM ID	1
14	92901222	Hose, Fkd 20/28 MM	280 mm
15	46556672	Connector Reduced, Hose 16/Hose 20	1

ITEM	P/N	DESCRIPTION	QTY.
16	46556712	Water Hose, Radiator Filler (Only Drawing)	1
17	92762723	Clip, Jubilee No 1A 20-30 MM	5

Procedure

Figure 1

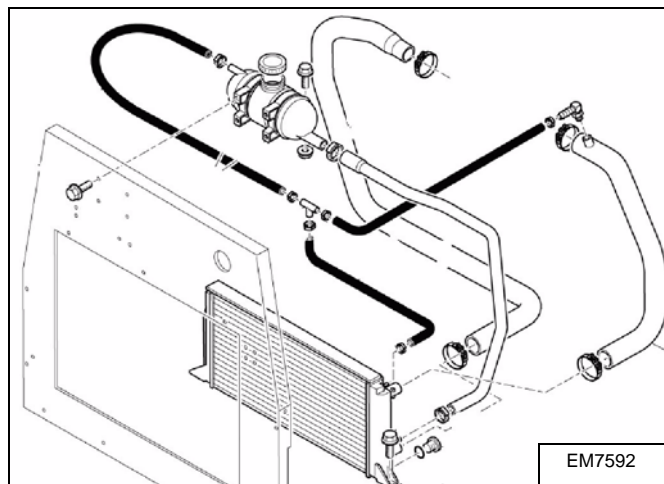

Drain the coolant.

Remove the old coolant header tank as shown [Figure 1].

Figure 2

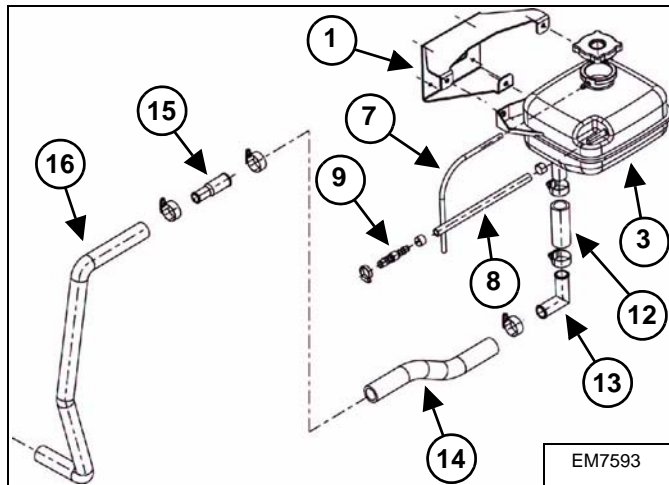

Install the bracket (Item 1) **[Figure 2]** using the four screws (Item 2).

Install the coolant header tank (Item 3) on the bracket (Item 1) **[Figure 2]** using the three screws (Item 4), washers (Item 5) and locknuts (Item 6).

Connect the hose (Item 7) to the coolant header tank (Item 3) **[Figure 2]**.

Install the hose (Item 8) and connector (Item 9) **[Figure 2]** as shown using the two clips (Item 10).

Use the hose clamp (Item 11) to connect the connector (Item 9) **[Figure 2]** to the hose (p/n 54577184) on the machine.

Install the hose (Item 12) and elbow (Item 13), hose (Item 14), connector (Item 15) and water hose (Item 16) **[Figure 2]** as shown using the five hose clips (Item 17).

Refill the coolant. Run the unit until it is warm. Stop the unit and check the coolant level. Top up if needed.

Tie down the hoses where needed.

Make sure that the hoses are mounted stress free to the coolant header tank.

Check that there is no rubbing or hoses against any other machine parts.