



Doosan Infracore
Portable Power

Service Letter

SL: 40022
Date: 17 October 2011
Product: Compressors
Subject: Drive Coupling Failure

MODEL	SERIAL NUMBER
P260 / HP220WYM-T3	D82
P250WJD-T3	D81
P250WJD-T4i	E32

Figure 1

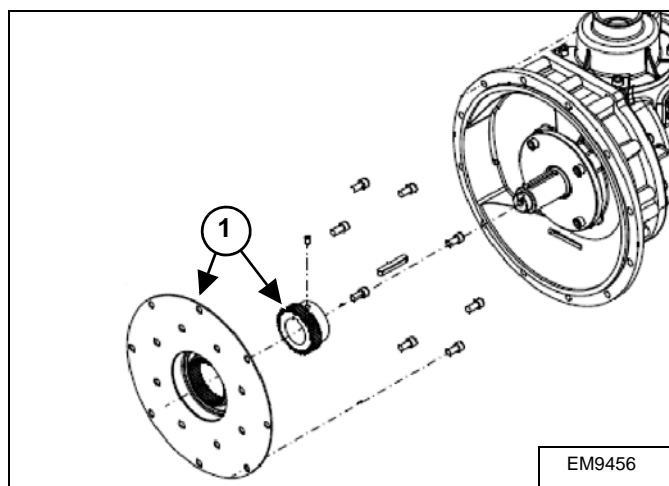

[Figure 1] Doosan Infracore has determined that the compressors listed in this letter may fail to have air output due to failure of the air end drive coupling (Item 1).

Therefore a new drive coupling kit has been released and can be installed on these machines. When replacing the drive coupling, order the complete kit (p/n 46577699).

Kit (p/n 46577699)

ITEM	P/N	DESCRIPTION	QTY.
1	22314348	Coupling Outer Member	1
2	22317679	Spacer	1
3	36880995	Bolt, M10-1.5x30 (For P260 / HP220WYM [Yanmar] type)	8
3	36881704	Bolt, 3/8-16x1.25" (For P250WJD [John Deere] type)	8
4	36769289	Key	1
5	46577619	Hexagon Steel Bushing	1
6	95376943	Set Screw	1

Removal Procedure

Figure 2

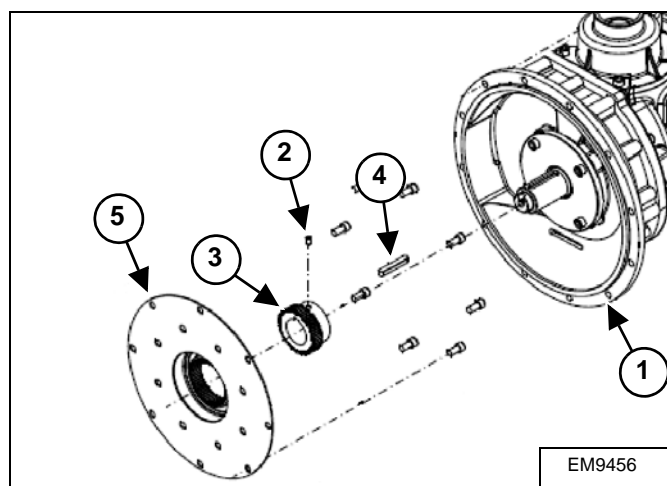

Remove the air end (Item 1) **[Figure 2]** from the engine.

Remove the set screw (Item 2) and remove the bushing (Item 3) from the air end shaft. Remove the key (Item 4) **[Figure 2]** from the air end shaft.

Remove the coupling (Item 5) **[Figure 2]** from the engine flywheel by removing the eight bolts.

Installation Procedure

Figure 1

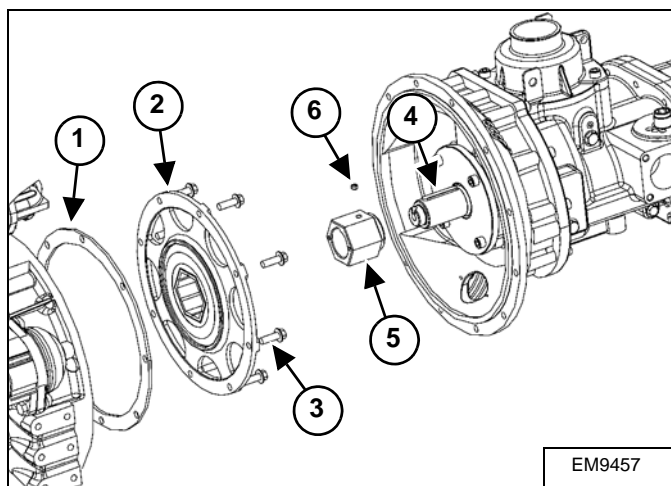
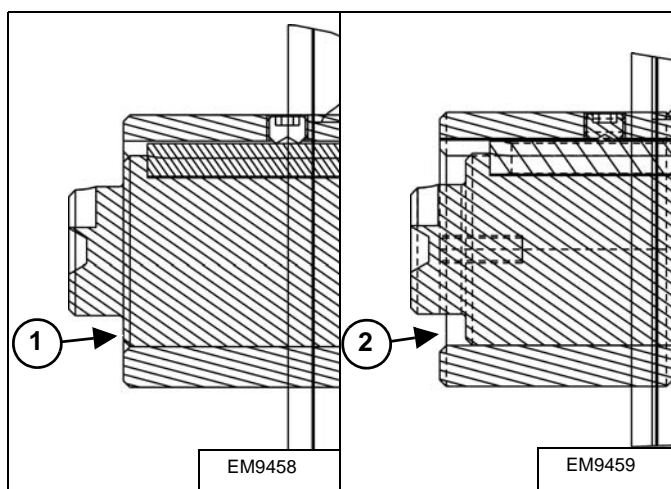

Figure 2



Install the spacer (Item 1) and the coupling outer member (Item 2) to the engine flywheel using the eight bolts (Item 3) [Figure 1].

Use the bolts (p/n 36880995) for P260 / HP220WYM (Yanmar) type and bolts (p/n 36881704) for P250WJD (John Deere) type.

NOTE: Apply loctite® 242 to the threads of the bolts and tighten to 51,5 N•m (38 ft-lb.) torque for P260 / HP220WYM (Yanmar) type and to 42,0 N•m (31 ft-lb.) torque for P250WJD (John Deere) type.

Install the key (Item 4) [Figure 1] on the airend shaft.

Slide the hexagonal bushing (Item 5) [Figure 1] on the airend shaft.

NOTE: Make sure the small diameter end of the hexagonal bushing is towards the airend.

For P260 / HP220WYM (Yanmar) type: make sure the back of the hexagonal bushing is flush with the step in the airend shaft as shown in (Item 1) [Figure 2].

For P250WJD (John Deere) type: make sure there is 6 mm (0.24 in) space between the back of the hexagonal bushing and the step in the airend shaft as shown in (Item 2) [Figure 2].

Apply loctite® 242 to the set screw (Item 6) [Figure 1]. Install the set screw in the hexagonal bushing and tighten to 24,4 N•m (18 ft-lb.) torque.

Install the airend on the engine. Make sure that the hexagonal bushing (Item 5) mates with the bushing on the coupling outer member (Item 1) [Figure 1].

NOTE: To facilitate the installation of the coupling outer member on the hexagonal bushing, a special lubricant (P-80® Emulsion) can be used. If this brand is unavailable in your market we strongly suggest using a local alternative with similar specification to avoid any damage to the rubber parts.

P-80® Emulsion Temporary Assembly Lubricant

P-80® Emulsion Temporary Assembly Lubricant is a biodegradable assembly aid that eases installation of tight-fitting rubber and plastic parts by reducing the force needed for insertion. Once assembly is complete, the lubricant dries and the part returns to its original condition. P-80® Temporary Assembly Lubricants can be applied manually or automatically, by dip, brush, or spray techniques. P-80® Emulsion Temporary Assembly Lubricant is used to install hoses, o-rings, seals, bushings, gaskets, grommets, grips, and many more other rubber and plastic parts. Use P-80® Emulsion when a thin film of lubricant is desired. Typical viscosity of P-80® Emulsion: 110 cps at 25° C.

Coupling failures will be reimbursed under the normal warranty rules 2 years / 4000 hours, unless proven to be a result of engine performance issues or other factors not related to coupling quality.