

DIRECT TO:

PARTS MANAGER ☒
 SERVICE MANAGER ☒
 SALES MANAGER ☒

INGERSOLL RAND TECHNICAL SERVICE BULLETIN

Bulletin #: GEN - 010
Date: 26/07/2006 Revised (10-12)
Product: GENERATORS
Subject: New RCD Resys M40

Doosan purchased Bobcat Company from Ingersoll-Rand Company in 2007. Any reference to Ingersoll-Rand Company or use of trademarks, service marks, logos, or other proprietary identifying marks belonging to Ingersoll-Rand Company in this manual is historical or nominative in nature, and is not meant to suggest a current affiliation between Ingersoll-Rand Company and Doosan Company or the products of either.

MODELS	SERIAL NUMBER
All generator models with adjustable RCD	

Recently we have installed a new type of RCD (Residual Current Device or earth leakage protection) on our generators. The new type of RCD is the Socomec Resys M40.

The number of the terminals on the new RCD differs from the old one. Below you see the old and the new terminal numbers.

Old Version:

1	+ Feed	(cable number 1)
2	- Earth	(cable number 2&9)
8	CT coil	(cable number 3)
9	CT coil	(cable number 4)
11	Alarm signal	(cable number 5)
13	Alarm signal	(cable number 6)
18	Output to MX coil	(cable number 8)
19	Output to MX coil	(cable number 7)

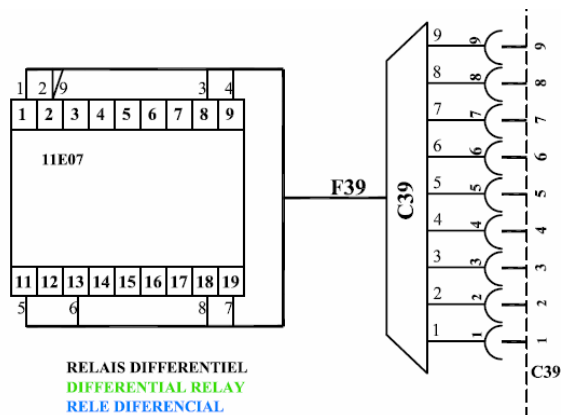

Old Version

New version:

5	+ Feed	(cable number 1)
7	- Earth	(cable number 2&9)
8	CT coil	(cable number 3)
9	CT coil	(cable number 4)
12	Alarm signal	(cable number 5)
14	Alarm signal	(cable number 6)
10	Output to MX coil	(cable number 8)
11	Output to MX coil	(cable number 7)

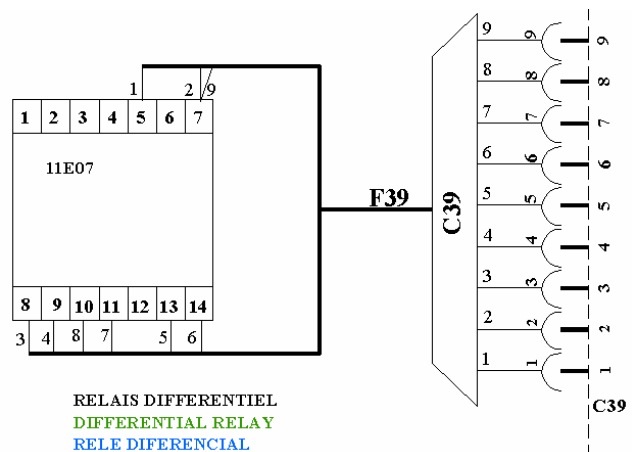

New Version

If you have to change an old RCD with a new type, just connect the cables as shown in the above drawing. You can use the CT of the old RCD for the new RCD. Always check if the dipswitches on the new RCD are in the “on” position.

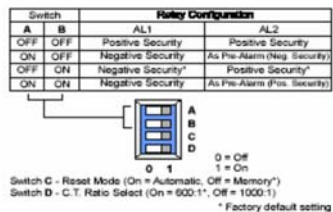

Adjusting new RCD:

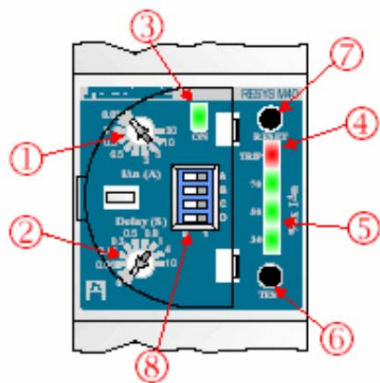

1. Trip level (standard 0.03)
2. Time delay (standard 0)
3. Green supply “On”
4. Red trip LED
5. LED barograph
6. “Test” button
7. “Reset” button
8. Dip switches

A more detailed description of the Resys M40 you can find in the enclosed datasheets (in several languages)